

# Ferrite

## For Switching Power Supplies

### E Cores

## EER Bobbins

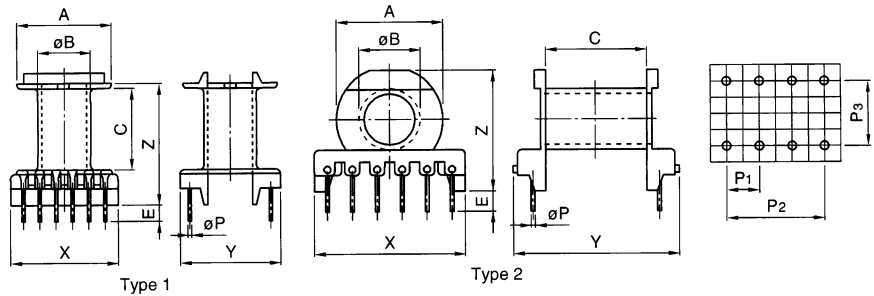

Part No.	Type	Dimensions in						
		A	$\phi B$	C	E	X	Y	Z
BEER25.5-118CPFR	1	19.53	9.9	10.05	4.5	22.0	19.6	19.05
		.769	.390	.396	.177	.866	.772	.750
BEER28-1110CPFR	1	20.9	12.3	16.7	4.5	24.8	23.0	26.6
		.823	.484	.657	.177	.976	.906	1.047
BEER28L-1110CPFR	1	20.9	12.3	22.4	4.5	24.8	23.0	32.3
		.823	.484	.882	.177	.976	.906	1.272
BEER35-1112CPFR	1	25.4	13.7	26.1	5.5	30.0	28.5	39.3
		1.000	.539	1.028	.217	1.181	1.122	1.547
BEER40-1112CPFR	1	28.7	15.8	27.5	5.0	32.0	30.0	41.7
		1.130	.622	1.083	.197	1.260	1.181	1.642
BEER42-1114CPFR	1	29.1	17.95	27.5	5.0	38.0	30.0	42.7
		1.146	.707	1.083	.197	1.496	1.181	1.681
BEER42/20-1112CPFR	1	31.5	19.8	27.3	5.0	43.5	37.0	42.5
		1.240	.780	1.075	.197	1.713	1.457	1.673
BEER49-1118CPFR	1	35.95	20.3	21.45	4.5	49.0	37.0	39.45
		1.415	.799	.844	.177	1.929	1.457	1.553
BEER28-1112CPHFR	2	20.9	12.0	16.1	5.0	30.0	31.3	25.0
		.823	.472	.634	.197	1.181	1.232	.984
BEER28L-1112CPHFR	2	20.9	12.0	21.8	5.0	30.0	37.0	25.0
		.823	.472	.858	.197	1.181	1.457	.984
BEER35-1116CPHFR	2	25.2	13.6	26.4	4.5	40.0	45.5	29.0
		.992	.535	1.039	.177	1.575	1.791	1.142
BEER40-1116CPHFR	2	28.6	15.7	27.5	4.2	40.0	44.0	31.8
		1.126	.618	1.083	.165	1.575	1.732	1.252
BEER42-1116CPHFR	2	29.0	18.0	27.3	5.0	40.0	44.0	34.5
		1.142	.709	1.075	.197	1.575	1.732	1.358

\* Please see the next page additionally.

**Ferrite****EER Bobbins**

For Switching Power Supplies  
E Cores

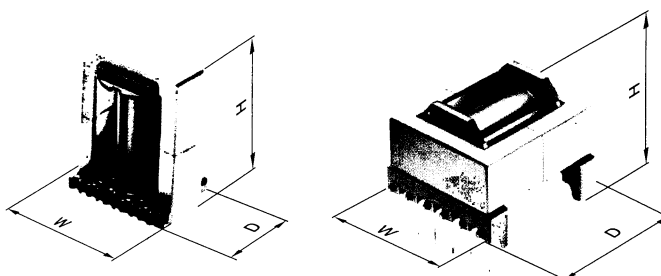

t*	øP (mm)	P1 (mm)	P2 (mm)	P3 (mm)	Terminal pins	W D H (mm)	Parameter		Wt (g)
							Aw (mm <sup>2</sup> )	ℓ w (mm)	
0.8	0.8	5.0	15	12.5	8	26 20 21	48.4	46.2	2.7
0.8	0.8	5.0	20	17.5	10	29 23 29	71.8	52.2	3.5
0.8	0.8	5.0	20	17.5	10	29 23 35	96.3	52.2	3.9
0.8	1.0	5.0	25	22.5	12	36 29 44	152.7	61.4	7.7
0.8	1.0	5.0	25	25	12	41 30 46	178.8	69.9	8.9
0.8	1.0	5.0	30	25	14	43 30 47	153.3	73.9	9.8
0.8	1.0	7.5	37.5	30	12	43 37 46	159.7	80.6	12
0.9	0.8	5.0	40	30	18	50 37 43	167.8	88.4	15
0.8	0.8	5.0	25	25	12	31 32 26	71.6	51.6	5.2
0.8	0.8	5.0	25	30	12	31 38 26	97.0	51.7	5.5
0.8	∅0.75	5.0	35	35	16	41 46 31	154.4	60.8	11
0.8	1.0	5.0	35	35	16	41 45 32	170.6	69.9	11
0.8	1.0	5.0	35	35	16	43 46 35	148.5	73.8	12

UL Grade: 94V-0, Material: FR phenol, Pin material: Steel wire (Solder plated)

Maximum number of turns N that can be wound on bobbins, see section of "Maximum number of Turns on Bobbins".

\* Minimum thickness of bobbin inside which core is placed, including flanges.

\* Please see the former page additionally.